

SERIES : 32D

3/2 DIRECT ACTING, HIGH ORIFICE UNIVERSAL SUBBASE MOUNTED SOLENOID VALVE

| TYPE | PRESSURE |
|------|----------|
| | |
| | |
| | |

| TYPE | PRESSURE |
|------|----------|
| | |
| | |
| | |

| TYPE | PRESSURE |
|-------|------------|
| 30316 | 0 - 10 bar |
| 30317 | 0 - 10 bar |
| 30332 | 0 - 20 bar |

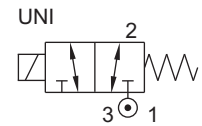

FEATURES

- Bubble tight shut OFF
- Mounts in any position
- Suitable for Vacuum up to 10⁻⁶ torr
- Vibration resistance up to 9g
- Suitable for high speed cycling
- Speed up to 800 cycles/ min
- Life >10 million cycles
- O Rings and fasteners supplied loose with the valve

WETTED PARTS

| Code | ※ | B1 | B2 | B5 |
|-----------------|-----------------------------|--------------------|------------------|--------|
| Body | Anodized Aluminium | Anodized Aluminium | Brass | SS 316 |
| Internals | Aluminium, Brass and SS 316 | SS 316 | Brass and SS 316 | SS 316 |
| Guide Assembly | SS 304 | | | |
| Shadow-Ring | Copper/ Silver/ None | | | |
| Plunger, Insert | SS 430 | | | |
| Spring | SS 302 | | | |
| Fasteners | SS 304 | | | |
| Seat, Seals | NBR, Viton | | | |

※ Do not specify code if opted

AMBIENT AND FLUID TEMPERATURE

-20 °C to 80 °C

SPECIAL VERSION AND SUFFIX

Suffix : (Valve) OX, AM, WO
 Special version : (Solenoid) CO, FR, SS, LC, III

MEDIA

Air, Inert Gases, Water, Vacuum, Free Flowing Liquid, Oil, Diesel, Kerosene, LPG

APPLICATION

Single acting actuator/ Cylinder/ control valve actuation

PORT CONNECTION

| | INLET | OUTLET | EXHAUST |
|-----------|-------|--------|---------|
| NC | 1 | 2 | 3 |
| NO | 3 | 2 | 1 |
| Diverting | 1 | 2 | 3 |
| Mixing | 3 | 2 | 1 |

Contact Rotex for

- Any other ambient, fluid temperature, media and application
- UL listed, Listed general purpose Valve
- SIL4 approved valve

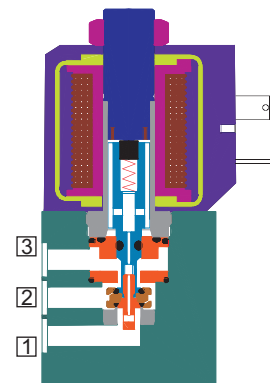
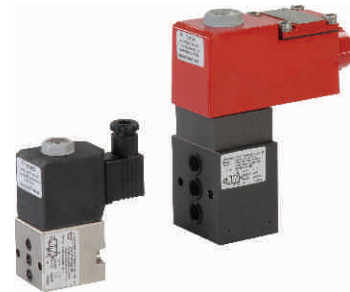

SPARES

(Refer page 25 for ordering code)

| SPARE KIT | CODE |
|--|------|
| Seal Kit : Oring Set and Plunger Assembly | 98 |
| Repair Kit : Oring Set, Plunger Assembly, Fastener, Springs, Manual Override | 99 |
| Solenoid Kit : Solenoid, Gasket and Nut | 34 |

APPROVAL

(* applied for)

| Approval | Nema 4X | IP67 | Ex d IIC T4 or T5 or T6 IP66 | Ex ia IIC T6 IP67 | DGMS | CCOE |
|----------|---------|------|------------------------------|-------------------|------|------|
| | | ✓ | ✓ | ✓ | * | ✓ |
| | | ✓ | ✓ | ✓ | | |
| | ✓ | | * | | | |
| | | | ✓ | ✓ | | |
| | | | ✓ | ✓ | | |
| | | | * | * | | |



Select Manifold type MF005/ MF006/ MF007/ MF017 for Valve type 30316 operated with AC voltage select Solenoid with in built full rectifier 'FR' option

3/2 DIRECT ACTING, HIGH ORIFICE UNIVERSAL SUBBASE MOUNTED SOLENOID VALVE

9

SPECIFICATION

| SIZE | PORT CONNECTION | | PRE-SSURE bar | | ORIFICE (mm) | FLOW FACTOR kv (LPM OF WATER @ 1 bar ΔP) | VALVE TYPE | PILOT PRESSURE | BODY MATERIAL AND INTERNALS | | | | | SEALS | | | | | MANUAL OVERRIDE | | SOLENOID ENCLOSURE | | | | SUFFIX | | POWER VA | | CONSTRUCTION REFERENCE NUMBER |
|----------------------|-----------------|--------|---------------|---------|--------------|--|------------|----------------|-----------------------------|----------------|-------|-------------|-----|-------|------|--------|------|-----|-----------------------|-----------|--------------------|---------------|-------------------|-------------------|--------------------------|-----------------|---------------|--------|-------------------------------|
| | BSP(F) | NPT(F) | MINIMUM | MAXIMUM | | | | | ALUMINIUM | ALUMINIUM + SS | BRASS | SS 316/CF8M | NBR | Viton | EPDM | HYTREL | PTFE | NIL | STAYPUT CUM MOMENTARY | MOMENTARY | FLYING LEAD | PLUG IN, IP67 | SQ. PLUG IN, IP67 | TERMINAL BOX IP67 | Ex d IIC, T4 OR T6, IP67 | LARGE ENCLOSURE | SOLENOID SIZE | OXYGEN | |
| 3/2 UNIVERSAL | | | | | | | | | | | | | | | | | | | | | | | | | | | | | |
| SB | 0 | 10 | 5 | 8 | 30316 | | * | B2 | B5 | * | S2 | S1 | | * | M6 | M8 | F | 22 | | T | E | III | 14 | ✓ | 18 | 12 | 8 | 708 | |
| | 0 | 10 | 7 | 14 | 30317 | | * | B2 | B5 | * | S2 | S1 | | * | M6 | M8 | F | 25 | | T | E | 18 | ✓ | 13 | 13 | 13 | 709 | | |
| | 0 | 10 | 10 | 30 | 30317 | | * | B2 | B5 | * | S2 | S1 | | * | M6 | M8 | F | 25 | | T | E | 18 | ✓ | 13 | 13 | 13 | 710 | | |
| | 0 | 10 | 7 | 14 | 30332 | | * | B2 | B5 | * | S2 | S1 | | * | M6 | M8 | F | 25 | | T | E | 18 | ✓ | 13 | 13 | 13 | 709 | | |
| | 0 | 20 | 10 | 30 | 30332 | | * | B2 | B5 | * | S2 | S1 | | * | M6 | M8 | F | 25 | | T | E | 18 | ✓ | 13 | 13 | 13 | 710 | | |

| | | | | |
|-------------|----|----|------------------|-----------------------------------|
| Cable Entry | T | E | F | ※ = Do not specify when opted for |
| M20 x 1.5 | 19 | 39 | Flying lead IP54 | ※ |
| 1/2" NPT | 16 | 37 | Flying lead IP67 | 01 |

✓ = Options available

ORDERING CODE VALVE + SOLENOID

TYPE - SUFFIX - ORIFICE - PORT CONNECTION - BODY AND INTERNALS - MANUAL OVERRIDE - SEAL + SIZE - VOLTAGE - CURRENT - SOLENOID ENCLOSURE - APPROVAL - INSULATION - SPECIAL VERSION
 e.g. 30316-5-SB+220V 50Hz-19-FR-III

DIMENSIONS

All Dimensions are in mm

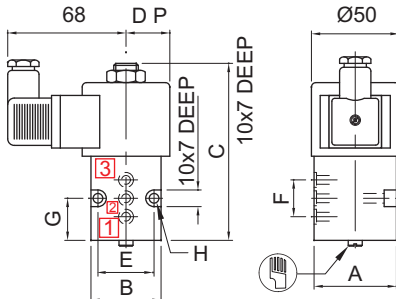

PLUG IN SOLENOID TYPE 22/ 25

MANUAL OVERRIDE OPTIONALLY PROVIDED.

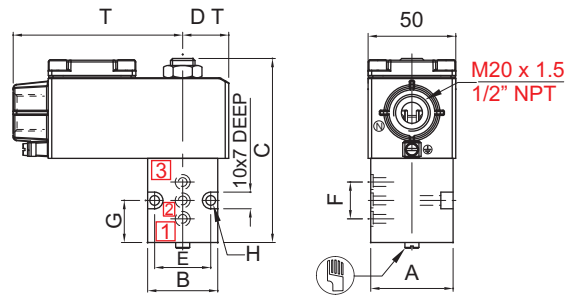

TERMINAL BOX/ Ex d LARGE ENCLOSURE, TYPE 16, 19, 37, 39

MANUAL OVERRIDE OPTIONALLY PROVIDED.

| NW | K (PORT SIZE) | A | B | C | DP DT | E | F | G | H | T | CONST. REF. |
|---------------------------|---------------|----|----|-----|-------|----|----|----|-----|-----|-------------|
| VALVE TYPE : 30316 | | | | | | | | | | | |
| 5 | SUBBASE | 47 | 40 | 105 | 22 | 32 | 21 | 24 | 5.5 | 97 | 708 |
| VALVE TYPE : 30317 | | | | | | | | | | | |
| 7 | SUBBASE | 50 | 40 | 146 | 25 | 36 | 27 | 11 | 6.5 | 103 | 709 |
| 10 | SUBBASE | 60 | 50 | 160 | 30 | 38 | 35 | 16 | 6.5 | 103 | 710 |

ADOPTER PLATE

Adopter plate is used for mounting 1 No. 30316 valve. This has individual inlet, outlet and exhaust ports.

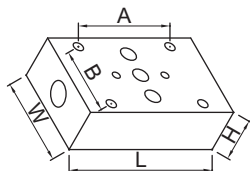

| ADOPTER PLATE | K (PORT SIZE) | L | W | H | A | B |
|---------------|---------------|-----|----|----|----|----|
| AP2A | 1/4" | 100 | 50 | 32 | 64 | 38 |
| AP2B | 3/8" | 110 | 60 | 36 | 64 | 38 |
| AP2C | 1/2" | 136 | 80 | 40 | 64 | 38 |