

# DECI

**Company:** Guangzhou Ruiheng Science&Technology Co., Ltd.  
**Wechat:** RH13054422780  
**Mobile:** +86 13054422780  
**Contact Person:** Mr.Polo Zhou (Global Sales)  
**Location:** Zengcheng district,Guangzhou  
 city.Guanadong,China  
**Email:** [deci.ruiheng@gzruihengkj.com](mailto:deci.ruiheng@gzruihengkj.com)



**Recommended models for dental milling machine:**

Model #	Speed (RPM)	Power	Bearing φ(mm)	Volt	Frequency	Collet	Tool Changi	Coolant	Torque (N.M)	Suitable material	Other info
DC-33A	80000	0.25KW	33mm	DC 72V	1333Hz/ 1000Hz	Φ3.175/φ 4	Automatic	Air	0.04	Zirconium oxide,wax, PMMA, presintered CrCo,PEEK	Clamp Mount
DC-38-0.75F	60000	0.35KW	38.5mm	100V(3-)	1000Hz	Φ3/φ 3.175/φ4	Automatic	Air	0.056	Zirconium oxide,wax, PMMA, presintered CrCo,PEEK	Clamp Mount
DC-40V6L3A	80000/ 60000	0.35KW	40mm	60V/ 100V(3-)	1333Hz/ 1000Hz	Φ3/φ 3.175/φ4	Automatic	Air	0.056	Zirconium oxide,wax, PMMA, presintered CrCo,PEEK	Clamp Mount
DC-40V3CHA	80000	0.35KW	40mm	60V(3-)	1333Hz	Φ3.175	Manual	Air	0.056	Zirconium oxide,wax, PMMA, presintered CrCo,PEEK	Clamp Mount
DC-62G1	60000	2.2KW/ 1.8KW/ 1.5KW/ 1.2KW	61.9mm	220V(3-)	1000Hz	Φ3-φ6	Automatic	Water	0.35/ 0.28/ 0.24/ 0.19	Glass ceramics, composites, cobalt chrome and titanium	Clamp Mount
		2.2KW/ 1.8KW/ 1.5KW/ 1.2KW							0.35/ 0.28/ 0.24/ 0.19		
		2.2KW/ 1.8KW/ 1.5KW/ 1.2KW							0.35/ 0.28/ 0.24/ 0.19		
		2.2KW/ 1.8KW/ 1.5KW/ 1.2KW							0.35/ 0.28/ 0.24/ 0.19		
DC-62B3	60000	2.2KW/ 1.8KW/ 1.5KW/ 1.2KW	61.9mm	220V(3-)	1000Hz	Φ3-φ6	Automatic	Water	0.35/ 0.28/ 0.24/ 0.19	Glass ceramics, composites, cobalt chrome and titanium	Clamp Mount
DC-60D2	60000	2.2KW/ 1.8KW/ 1.5KW/ 1.2KW	61.9mm	220V(3-)	1000Hz	ER11	Manual	Water	0.35/ 0.28/ 0.24/ 0.19	Glass ceramics, composites, cobalt chrome and titanium	Clamp Mount
DC-62V2	60000	2.2KW/ 1.8KW/ 1.5KW/ 1.2KW	61.9mm	220V(3-)	1000Hz	ISO10- ER11	Automatic	Water	0.35/ 0.28/ 0.24/ 0.19	Glass ceramics, composites, cobalt chrome and titanium	Clamp Mount
DC-62T11V2	60000	2.2KW/ 1.8KW/ 1.5KW/ 1.2KW	61.9mm	220V(3-)	1000Hz	T11- ER11	Automatic	Water	0.35/ 0.28/ 0.24/ 0.19	Glass ceramics, composites, cobalt chrome and titanium	Clamp Mount
DC-62T11V2YC	60000	2.7KW PMSM	61.9mm	220V(3-)	1000Hz	T11- ER11	Automatic	Water	0.43	Glass ceramics, composites, cobalt chrome and titanium	Clamp Mount
DC-80D	40000	4KW/ 3.7KW/ 2.5KW	80mm	380V/ 220V(3-)	1333Hz	Φ6/φ8/φ 10	Automatic	Water	1.27/ 0.88/ 0.6	Glass ceramics, composites, cobalt chrome and titanium	Clamp Mount
DC-0840K	40000	4KW/ 3.7KW/ 2.5KW	80mm	380V/ 220V	1333Hz	ISO20 - ER16	Automatic	Water	1.27/ 0.88/ 0.6	Glass ceramics, composites, cobalt chrome and titanium	Clamp Mount
DC-0840G1- HSK25E	40000	4KW/ 3.7KW/ 2.5KW	80mm	380V/ 220V(3-)	1333Hz	HSK25E- ER16	Automatic	Water	1.27/ 0.88/ 0.6	Glass ceramics, composites, cobalt chrome and titanium	Clamp Mount
DC-0840KH	40000	4KW/ 3.7KW/ 2.5KW	80mm	380V/ 220V(3-)	1333Hz	ER16	Manual	Water	1.27/ 0.88/ 0.6	Glass ceramics, composites, cobalt chrome and titanium	Clamp Mount



外形尺寸图  
Outline  
dimensional  
drawing

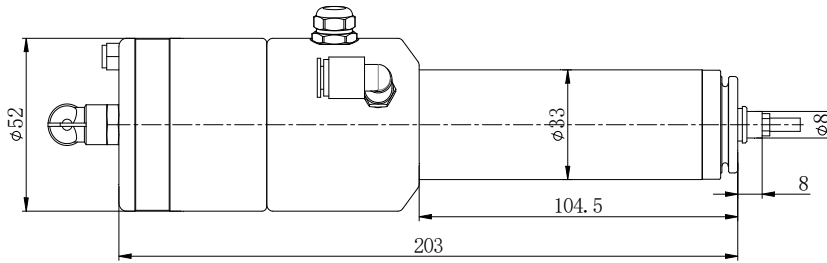

**DC-33A**

主轴参数 Spindle parameter

电机功率 Motor power	KW	0.25	额定电压 Rated voltage	V/DC	72 (DC)
最高转速 Maximum speed	Rpm	80000/60000	最大电流 Maximum current	A	5.5
最高频率 Maximum frequency	Hz	1333/1000	转矩 Torque	N·M	0.04

技术参数 Technical parameters

轴端锥面跳动 Shaft end cone runout	mm	≤0.001	松刀气压 Tool unloading	Kgf/cm <sup>2</sup>	5.0-6.0
换刀形式 Tool change form	—	自动 Automatic	前端气幕气压 Front curtain pressure	Kgf/cm <sup>2</sup>	—
拉刀力 Broach force	N	≥1000	回刀气压 Tool return pressure	Kgf/cm <sup>2</sup>	—
刀具接口 Tool interface	—	Φ3.175/Φ4 筒夹 collet chuck	冷却方式 Type of cooling	—	气冷 Air cooling
编码器 Encoder	—	—	冷却介质压力 Cooling medium pressure	Kgf/cm <sup>2</sup>	1.0 ~ 1.5
接近开关 Proximity switch	—	—	轴承润滑方式 Bearing lubrication mode	—	油脂 Grease
主轴平衡等级 Spindle balance class	—	G1	安装方式 Installation method	—	抱夹 Clamp
振动值 Vibration value	mm/s	≤0.8	重量 Weight	Kg	1.1

电机特性参考曲线  
Motor characteristic  
reference curve

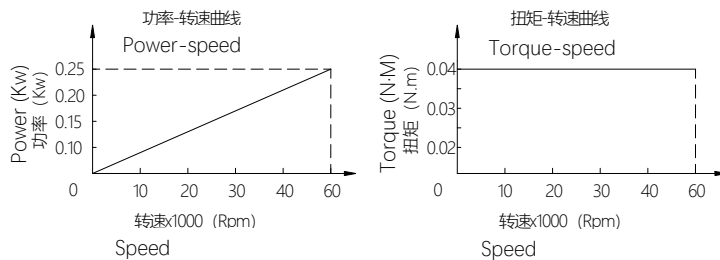

应用领域  
Application fields

适用于齿机氧化锆等软材料加工  
Suitable for denture machine zirconia and other soft materials processing

**DECI**

Engraving and milling spindle series



外形尺寸图  
Outline  
dimensional  
drawing

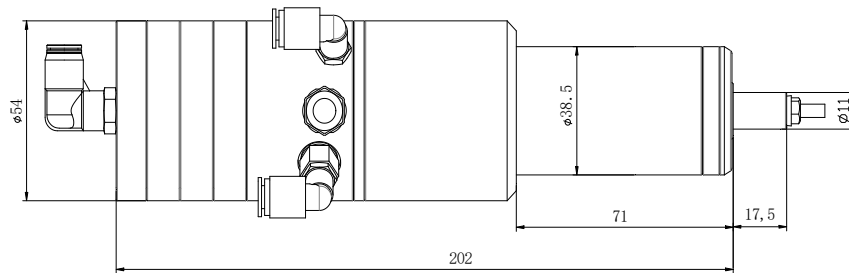

**DC-38-0.75F**

主轴参数 Spindle parameter

电机功率 Motor power	KW	0.35	额定电压 Rated voltage	V/AC	100 (3~)
最高转速 Maximum speed	Rpm	60000	最大电流 Maximum current	A	3.5
最高频率 Maximum frequency	Hz	1000	转矩 Torque	N·M	0.056

技术参数 Technical parameters

轴端锥面跳动 Shaft end cone runout	mm	≤0.001	松刀气压 Tool unloading	Kgf/cm <sup>2</sup>	5.0-6.0
换刀形式 Tool change form	—	自动 Automatic	前端气幕气压 Front curtain pressure	Kgf/cm <sup>2</sup>	—
拉刀力 Broach force	N	≥1000	回刀气压 Tool return pressure	Kgf/cm <sup>2</sup>	—
刀具接口 Tool interface	—	Φ3/Φ3.175/Φ4 筒夹 collet chuck	冷却方式 Type of cooling	—	风冷 Air cooling
编码器 Encoder	—	—	冷却介质压力 Cooling medium	Kgf/cm <sup>2</sup>	1.0 ~ 1.5
接近开关 Proximity switch	—	—	轴承润滑方式 Bearing lubrication	—	油脂 Grease
主轴平衡等级 Spindle balance class	—	G1	安装方式 Installation method	—	抱夹 Clamp
振动值 Vibration value	mm/s	≤0.8	重量 Weight	Kg	1.9

电机特性参考曲线  
Motor characteristic  
reference curve

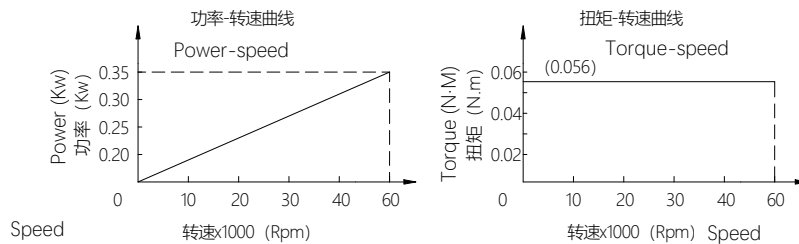

应用领域  
Application fields

适用于义齿机氧化锆等软材料加工  
Suitable for denture machine zirconia and other soft materials processing



外形尺寸图  
Outline  
dimensional  
drawing

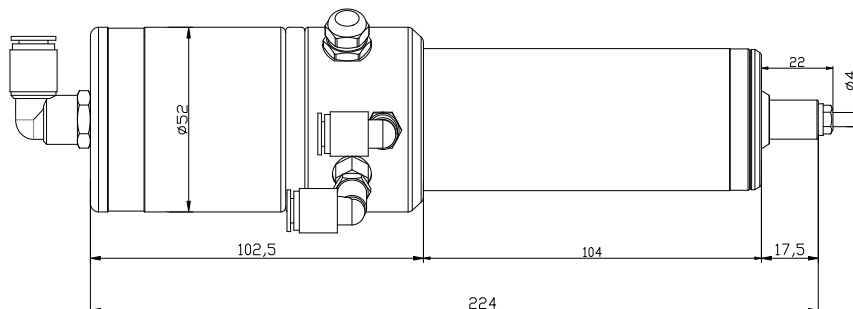

### DC-40V6L3A

主轴参数 Spindle parameter

电机功率 Motor power	KW	0.35	额定电压 Rated voltage	V/AC	60/100 (3~)
最高转速 Maximum speed	Rpm	80000/60000	最大电流 Maximum current	A	3.5
最高频率 Maximum frequency	Hz	1333/1000	转矩 Torque	N·M	0.056

技术参数 Technical parameters

轴端锥面跳动 Shaft end cone runout	mm	$\leq 0.001$	松刀气压 Tool unloading	Kgf/cm <sup>2</sup>	5.0-6.0
换刀形式 Tool change form	—	自动 Automatic	前端气幕气压 Front curtain pressure	Kgf/cm <sup>2</sup>	—
拉刀力 Broach force	N	$\geq 1000$	回刀气压 Tool return pressure	Kgf/cm <sup>2</sup>	—
刀具接口 Tool interface	—	$\phi 3/\phi 3.175/\phi 4$ 筒夹 collet chuck	冷却方式 Type of cooling	—	风冷 Air cooling
编码器 Encoder	—	—	冷却介质压力 Cooling medium pressure	Kgf/cm <sup>2</sup>	1.0 ~ 1.5
接近开关 Proximity switch	—	—	轴承润滑方式 Bearing lubrication	—	油脂 Grease
主轴平衡等级 Spindle balance class	—	G1	安装方式 Installation method	—	抱夹 Clamp
振动值 Vibration value	mm/s	$\leq 0.8$	重量 Weight	Kg	1.35

电机特性参考曲线  
Motor characteristic  
reference curve

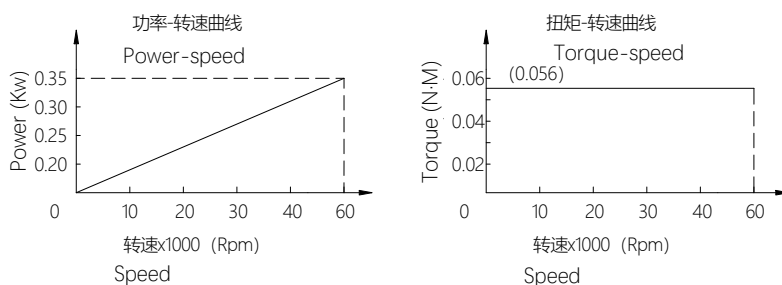

应用领域

适用于义齿机氧化锆等软材料加工  
Suitable for denture machine zirconia, PCB and other soft materials processing



外形尺寸图  
Outline  
dimensional  
drawing

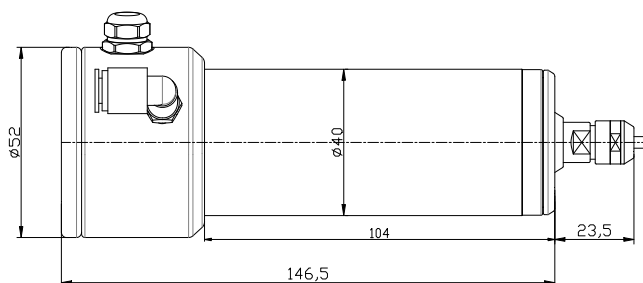

### DC-40V3CHA

主轴参数 Spindle parameter

电机功率 Motor power	KW	0.35	额定电压 Rated voltage	V/AC	60 (3~)
最高转速 Maximum speed	Rpm	80000	最大电流 Maximum current	A	3.5
最高频率 Maximum frequency	Hz	1333	转矩 Torque	N·M	0.056

技术参数 Technical parameters

轴端锥面跳动 Shaft end cone runout	mm	≤0.001	松刀气压 Tool unloading	Kgf/cm <sup>2</sup>	—
换刀形式 Tool change form	—	手动 manual operation	前端气幕气压 Front curtain pressure	Kgf/cm <sup>2</sup>	—
拉刀力 Broach force	N	—	回刀气压 Tool return pressure	Kgf/cm <sup>2</sup>	—
刀具接口 Tool interface	—	Φ3.175 筒夹 collet chuck	冷却方式 Type of cooling	—	风冷 Air cooling
编码器 Encoder	—	—	冷却介质压力 Cooling medium pressure	Kgf/cm <sup>2</sup>	1.0~1.5
接近开关 Proximity switch	—	—	轴承润滑方式 Bearing lubrication	—	油脂 Grease
主轴平衡等级 Spindle balance class	—	G1	安装方式 Installation method	—	抱夹 Clamp
振动值 Vibration value	mm/s	≤0.8	重量 Weight	Kg	1.35

电机特性参考曲线  
Motor characteristic  
reference curve

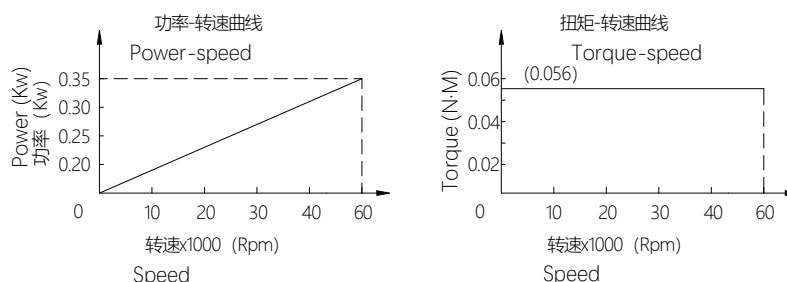

应用领域  
Application fields

适用于义齿机氧化锆等软材料加工  
Suitable for denture machine zirconia, PCB and other soft materials processing

**DECI**

Engraving and milling spindle series

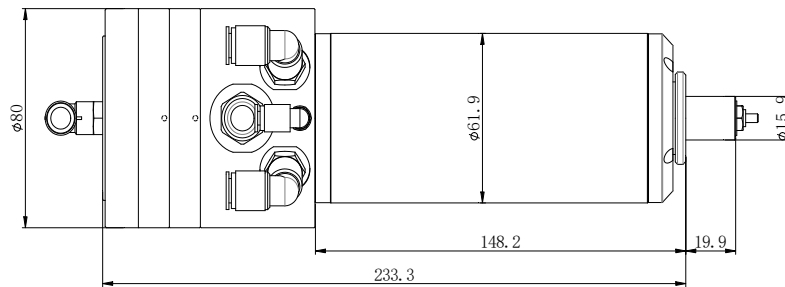

外形尺寸图  
Outline  
dimensional  
drawing

**DC-62B3**

主轴参数 Spindle parameter

电机功率 Motor power	KW	2.2/1.8/1.5/1.2	额定电压 Rated voltage	V/AC	220 (3~)
最高转速 Maximum speed	Rpm	60000	最大电流 Maximum current	A	7.2/6.5/5.0/4.3
最高频率 Maximum frequency	Hz	1000	转矩 Torque	N·M	0.35/0.28/0.24/0.19

技术参数 Technical parameters

轴端锥面跳动 Shaft end cone runout	mm	≤0.001	松刀气压 Tool unloading	Kgf/cm <sup>2</sup>	5.6-6.0
换刀形式 Tool change form	—	自动 Automatic	前端气幕气压 Front curtain pressure	Kgf/cm <sup>2</sup>	2.5 ~ 3.0
拉刀力 Broach force	N	≥1200	回刀气压 Tool return pressure	Kgf/cm <sup>2</sup>	—
刀具接口 Tool interface	—	Φ3-Φ6 筒夹 collet chuck	冷却方式 Type of cooling	—	水冷 Water cooling
编码器 Encoder	—	—	冷却介质压力 Cooling medium	Kgf/cm <sup>2</sup>	≥2.5
接近开关 Proximity switch	—	—	轴承润滑方式 Bearing lubrication	—	油脂 Grease
主轴平衡等级 Spindle balance class	—	G1	安装方式 Installation method	—	抱夹 Clamp
振动值 Vibration value	mm/s	≤0.8	重量 Weight	Kg	3.97

电机特性参考曲线  
Motor characteristic  
reference curve

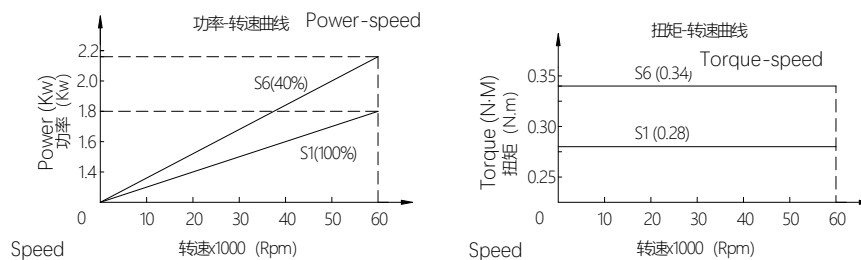

应用领域  
Application fields

适用于金属、非金属材料的高速、高精度钻、铣加工  
Suitable for high speed and high precision drilling and milling of metal and non-metal materials

**DECI**

Engraving and milling spindle series



外形尺寸图  
Outline  
dimensional  
drawing

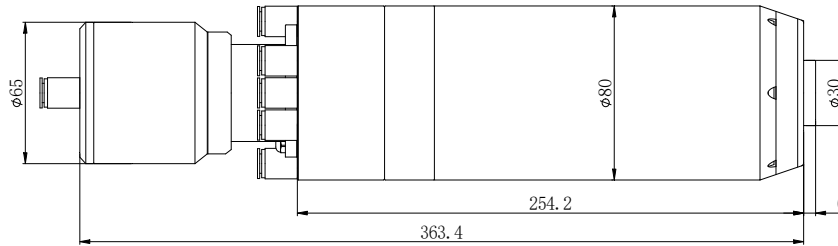

**DC-0840K**

主轴参数 Spindle parameter

电机功率 Motor power	KW	4.0/3.7/2.5	额定电压 Rated voltage	V/AC	380/220 (3~)
最高转速 Maximum speed	Rpm	40000	最大电流 Maximum current	A	7.5/7.1/4.8
最高频率 Maximum frequency	Hz	1333	转矩 Torque	N·M	1.27/0.88/0.6

技术参数 Technical parameters

轴端锥面跳动 Shaft end cone runout	mm	≤0.001	松刀气压 Tool unloading	Kgf/cm <sup>2</sup>	5.6-6.0
换刀形式 Tool change form	—	自动 Automatic	前端气帘气压 Front curtain pressure	Kgf/cm <sup>2</sup>	2.5 ~ 3.0
拉刀力 Broach force	N	≥1100	回刀气压 Tool return pressure	Kgf/cm <sup>2</sup>	5.6-6.0
刀具接口 Tool interface	—	ISO20 刀柄-ER16 ISO20 Shank-ER16	冷却方式 Type of cooling	—	水冷 Water cooling
编码器 Encoder	—	方波TTL(选配) Square wave TTL(opt)	冷却介质压力 Cooling medium	Kgf/cm <sup>2</sup>	≥2.5
接近开关 Proximity switch	—	PNP常开 PNP normally on	轴承润滑方式 Bearing lubrication	—	油脂 Grease
主轴平衡等级 Spindle balance class	—	G1	安装方式 Installation method	—	抱夹 Clamp
振动值 Vibration value	mm/s	≤0.8	重量 Weight	Kg	7.65

电机特性参考曲线  
Motor characteristic  
reference curve

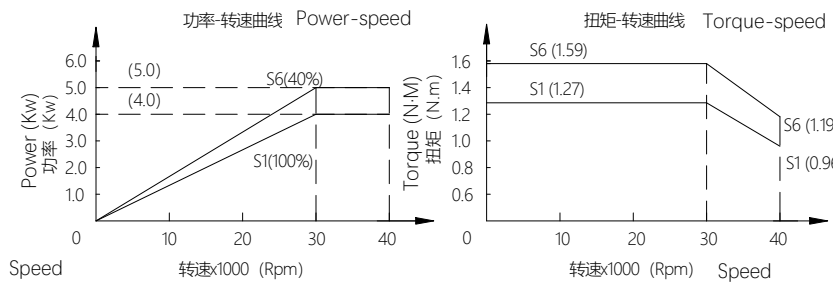

应用领域  
Application fields

适用于金属、非金属材料的高速、高精度铣削、钻孔、攻丝加工  
Suitable for high speed and high precision milling, drilling and tapping of metal and non-metal materials

**DECI**

Engraving and milling spindle series

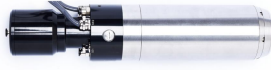

外形尺寸图  
Outline  
dimensional  
drawing

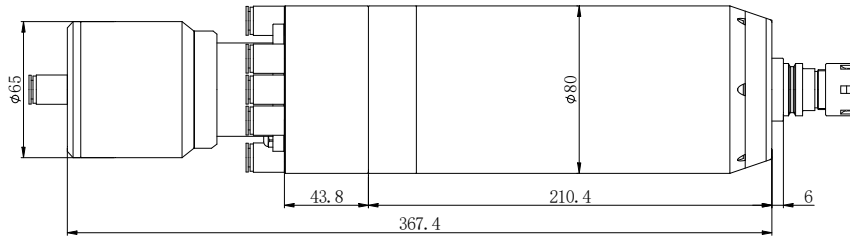

**DC-0840G1-HSK25E**

主轴参数 Spindle parameter

电机功率 Motor power	KW	4.0/3.7/2.5	额定电压 Rated voltage	V/AC	380/220 (3~)
最高转速 Maximum speed	Rpm	40000	最大电流 Maximum current	A	7.5/7.1/4.8
最高频率 Maximum frequency	Hz	1333	转矩 Torque	N-M	1.27/0.88/0.6

技术参数 Technical parameters

轴端锥面跳动 Shaft end cone runout	mm	≤0.001	松刀气压 Tool unloading	Kgf/cm <sup>2</sup>	5.6-6.0
换刀形式 Tool change form	—	自动 Automatic	前端气帘气压 Front curtain pressure	Kgf/cm <sup>2</sup>	2.5 ~ 3.0
拉刀力 Broach force	N	2800 (max)	回刀气压 Tool return pressure	Kgf/cm <sup>2</sup>	5.6-6.0
刀具接口 Tool interface	—	HSK25E-ER16	冷却方式 Type of cooling	—	水冷 Water cooling
编码器 Encoder	—	方波TTL(选配) Square wave TTL(opt)	冷却介质压力 Cooling medium pressure	Kgf/cm <sup>2</sup>	≥2.5
接近开关 Proximity switch	—	PNP常开 PNP normally on	轴承润滑方式 Bearing lubrication mode	—	油脂 Grease
主轴平衡等级 Spindle balance class	—	G1	安装方式 Installation method	—	抱夹 Clamp
振动值 Vibration value	mm/s	≤0.8	重量 Weight	Kg	7.65

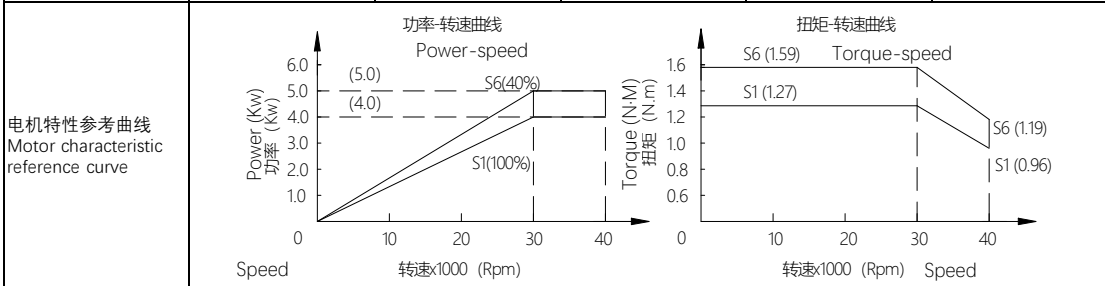

应用领域  
Application fields

适用于金属、非金属材料的高速、高精度铣削、钻孔、攻丝加工  
Suitable for high speed and high precision milling, drilling and tapping of metal and non-metal materials

We have many other models available and can also customize for partners, Please feel free to inquiry!